

ITEM NO.	DESCRIPTION	PartNo	QTY.
	PLATFORM, 18" PLATFORM HEIGHT, BREAKS DOWN FOR SHIPPING AND STORAGE	DC-BC-AJ-1-18	-
1	PLATFORM, 18" HEIGHT, PERFORATED DECK, REMOVABLE ALUMINUM RAILING	AJADJ-PLT18PERF	1
2	STAIR, 1 STEP, 9" RISE, PERFORATED TREADS, ALUMINUM RAILINGS	AJADJ-STR18PERF	1
3	RAILING CLAMP, 1 3/8" DIA	AJADJ-DKCLMP1_375	8

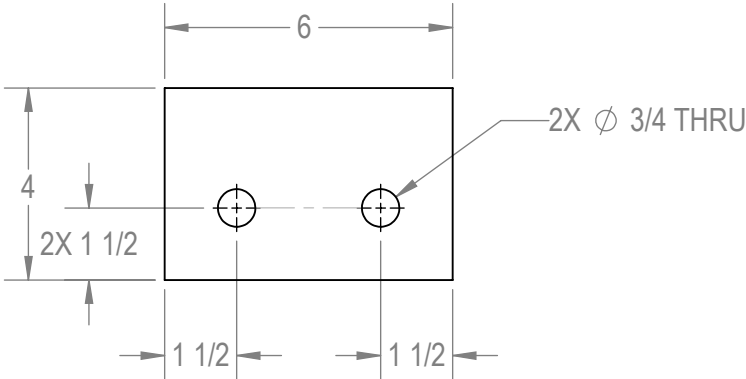
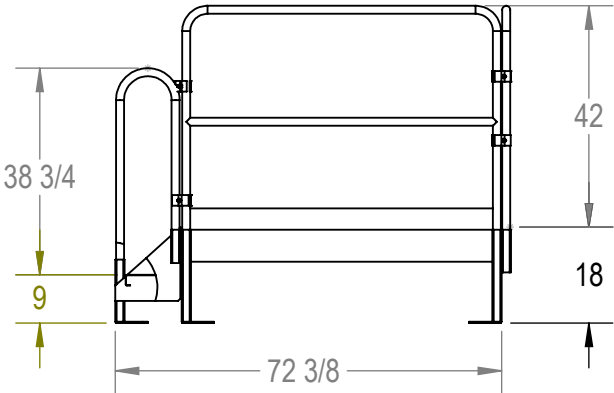
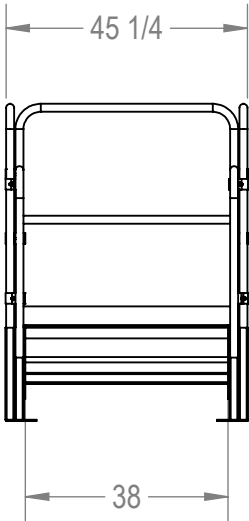
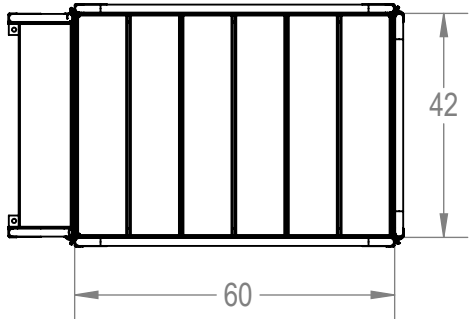

MOUNTNG PLATE DETAIL

DESIGN CRITERIA
CODE: OSHA 1910 SUBPART D
LIVE LOAD: PLATFORM: 500 LBS STAIR: 1000 LBS GUARDRAILS 200 LBS (ANY DIRECTION)

PROPRIETARY AND CONFIDENTIAL

THE INFORMATION CONTAINED IN THIS DRAWING IS THE SOLE DIVERSE SUPPLY, INC.. ANY REPRODUCTION IN PART OR AS A WHOLE WITHOUT THE WRITTEN PERMISSION OF DIVERSE SUPPLY, INC. IS PROHIBITED.

DIVERSE SUPPLY, INC.							
PO BOX 10997 ST. PETERSBURG, FL 33733 (888) 802-3651							
CAPACITY	500#		NAME	DATE	TITLE: PLATFORM, 18" PLATFORM FIXED HEIGHT, 500# CAPACITY, BREAKS DOWN FOR SHIPPING AND STORAGE, OSHA 1910 COMPLIANT		
FINISH	MILL	DRAWN					
MATERIAL	ALUMINUM	CHECKED	AG	04/30/23			
WEIGHT	153.46 LBS	COMMENTS:					
					SIZE	DWG. NO.	REV
					B	DS-BC-AJ18FSP	D
DO NOT SCALE DRAWING							SHEET 1 OF 1